

THE 56



EBA

Guillotines

THE 56

Cut from the future

Well-designed digital functions, intuitive controls, and easy to use: THE 56 makes guillotine work easier and more satisfying than ever – even on demanding projects. Enjoy optimised workflows and flawless precision.



PROGRAMM-MODUS

Messwert: 12.00

1	2	3	4	5	6	7	8	9	C
0	.	=	START						

12.00

5.00

297.00

5.00

EBA



Beautifully simple

15.6" diagonal size touchscreen –
use it just like a tablet



Easy on the hands, comfortable on the eyes:
The 15.6" multi-touch display has a continuously adjustable tilt and adapts perfectly to light conditions and the ergonomic needs of the user.

The smart user interface ensures any new user instantly feels at home. The display focuses the eye on the essentials – with intuitive touch and right when you need it – no more, no less.

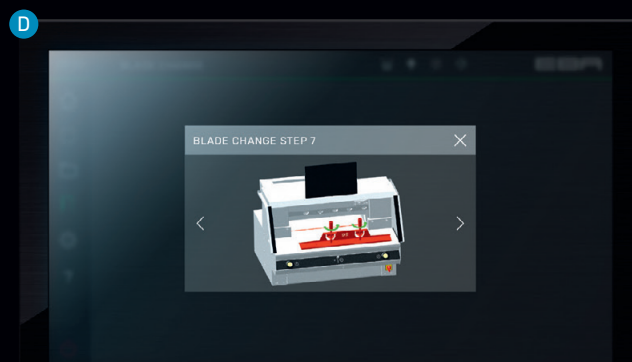
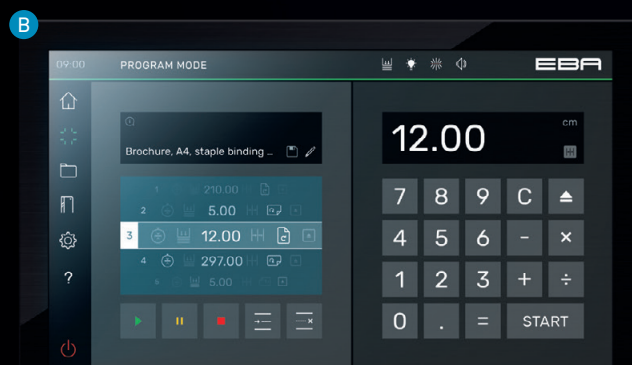
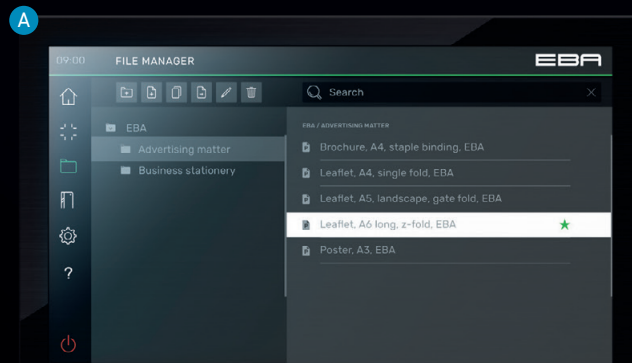

A File manager

Folder system with freely assignable tasks, selection of projects via USB, meaningful project names, and a time-saving search function

B Program mode

Single step display with active/inactive settings, cutting steps are separately editable, freely editable text field for customer-specific information

C Adjustable defaults

Operator-specific default clamping pressure and backgauge speed, automatic loading at switch-on

D Interactive assistance

Assistance swapping blades via animated videos, integrated help/FAQ in program, updates via download to the USB stick





56

centimetres
cutting length

PIN

electronic code lock
to secure the machine

3

switch between measuring
units: mm, cm, inch

Well-designed

The best equipment
for the best results.



Precise cutting edges for every cut and every type of paper: standard when working with THE 56. Of course, there is sophisticated technology behind this, but we have gone even further. The clever construction with the cleverly placed controls also ensures pleasantly smooth workflows – so you effortlessly achieve the best cutting results.



- A 15.6" multi-touch display**
Functional graphical user interface for intuitive tablet-like work and clear main screen with intelligently split display. The tilt adjustable display can be ergonomically adapted to body height and lighting conditions.
- B PRECISION DRIVE**
The manual fine adjustment of the backgauge ensures maximum precision – user-friendly via the ergonomic control element at the front of the machine.
- C EASY-TOUCH cut activating**
Safe true two-hand operation: A cut can be executed conveniently and safely by means of the EASY-TOUCH blade activating buttons with integrated optical signals indicating the operational status.
- D Mechanical foot clamp**
Ergonomic foot pedal for independent mechanical pre-clamping or as a mechanical cutting line indicator.



40 %

faster clamping and cutting
than the previous series

50 %

higher maximum clamping
pressure than the previous series

100 %

faster backgauge than
the previous series



Powerful performance

Redefining efficient
guillotining.

Precision

Whether you're a newbie or
an old hand, guillotine work
has never been easier.

Clean edges with every cut

precision-bearing blade guide
(patent pending)

electronically monitored
false clamp plate

manual fine adjustment
of the backgauge

Safety

Everything fits together perfectly – for flawless results and maximum safety.

Safety Cutting System (SCS)

IR light beam safety curtain

two-handed blade activation

IDEAL safety drive
(patent pending)

safe exchanging of blades

blade depth adjustment
from the outside

restricted access via
password protection



THE 56 is so smart that you're no longer forced to choose between precision and productivity.



Comfort

This hydraulic paper clamp system with adjustable and programmable clamping pressure alongside independent mechanical foot clamping is a patented-pending IDEAL in-house technology.

Ergonomically sound for every user

adjustable table height

integrated function for
exchanging cutting sticks

operator guidance via
colour signals

Quality in every detail



Next-generation programmable powered guillotine – for increased efficiency and productivity by working smarter. With IR light beam safety curtain and hydraulic clamp drive.

	THE 56
Cutting length (mm)	560
Cutting height (mm)	80 / 77*
Narrow cut (mm)	<15 / 60*
Table depth (mm)	560
Power (V/Hz/~)	230/50/1
Fuse protection (A)	16
Dimensions H x W x D (mm)	1523 x 979 x 1211
Dimensions W (mm) with side tables**	1779
Dimensions H (mm) without touch screen	1334
Table height (mm)	adjustable from 950–1000
Weight (kg)	approx. 303
Weight (kg) with cladding panels**	approx. 315
Weight (kg) with side tables**	approx. 316

* with false clamp installed

** optional accessories

Do you want to work even more comfortably?
 Stand cladding panels and side tables for
 THE 56 offer interesting expansion options.



Operation and programme control via 15.6" touchscreen display. Intuitive software with comprehensive features and operation via touch and swipe gestures – just like a tablet or smartphone.

	THE 56
Display (pixels)	1366 x 768
Operation	multi-touch
Connections	LAN, USB
Clamping pressure	programmable
Clamp pressure, min (daN)	approx. 250
Clamp pressure, max. (daN)	approx. 1000
Backgauge speed (cm/sec.)	up to approx. 10

www.eba.de

The technical data is approximate. Subject to change. 04/2022

